

The  
*HEATHCOTE*  
*Botanical Gardens*  
Story

1960

Mollie and Jim Crimmins move Heathcote Nursery from west Orange Avenue to the center of the town of Fort Pierce. (Heathcote Nursery was founded in Scarsdale, New York on Heathcote Street, and moved to Fort Pierce.) Heathcote's rare 3-headed Sabal palm is transplanted with the nursery to the 2.5 acre site.

1972

The Crimmins move their family home to the nursery site from Delaware Avenue, tying up traffic on U.S. 1 most of the day. The house was built in 1922 and now serves as the Heathcote administrative office.

1974

Mollie Crimmins salvages materials from a demolished bank on Okeechobee Road and builds the terraced Japanese Garden. Daughter Carol Crimmins Herzog's wedding is the first of many in the Gardens.

1986

The Crimmins decide to retire. The Nursery and house are on the market, and the 3-headed Sabal moves to Roy Rood's nursery on County Line Road in Hobe Sound.

## 1985

Heathcote Botanical Gardens is incorporated as a Florida not-for-profit organization.

Let the fund raisers begin!

## 1986

Heathcote Nursery is purchased with funding from Heathcote Inc., private donations and donations from the City of Fort Pierce, St. Lucie County and the State of Florida.

The first volunteer work days are held. Chesser Tractor Service and Contractor Paul Jacquin contribute manpower and equipment.

St. Lucie County contributes \$18,000 to install concrete trails and a restroom building.

## 1988

Bonsai collection of Jim Smith, Bonsai Master, loaned to Heathcote for Japanese Garden. Treasure Coast Bonsai Society begins maintenance of Japanese Garden.

First Annual Garden Festival. Event held every year thereafter on the weekend before Thanksgiving.

*Heathcote Botanical Gardens is a 501-C-3 Organization funded primarily by donations, events, memberships and admissions.*

1990

Director Lib Tobey begins her nine-year tenure, designing and installing specialty gardens including the Palm Walk, Herbaceous, Perennial and Bulb beds, the Bamboo Trail, Reflection Garden, Native Plants Garden and Rainforest.

1993

Walter Hill, Jr. (The Hill Foundation) donates \$25,000 for Entry Gift Shop building. Bob Terry Jr. donates architectural plans. HBG, Inc. raises over \$11,000 and many in-kind contributions of materials and labor, including construction by O.C. (Pete) Peterson and wood milled on the Adams Ranch. The entry building enables collection of admissions to begin in 1994.

1999

Walter Hill, Jr. (The Hill Foundation) donates \$25,000 matching funds to initiate Heathcote's Endowment Fund.

Heathcote Botanical Gardens is located on the southeast coast of Florida in USDA Plant Hardiness zone 9b, and has both native Florida flora as well as exotic flora from around the world. It is uniquely situated in a biological transition zone between a warm-temperate zone to the north and subtropical zone to the south. A transition zone contains species that are characteristic of the adjacent region to its north and south, as well as species that occur only in the transition zone. In the botanical world this is advantageous because it allows for greater diversity, which means that one may grow many kinds of plants from around the world that live under conditions associated with three climatic zones.

As one of the oldest communities on the east coast of Florida, Fort Pierce has borne witness to the changing tides of history for over 105 years. The days of one-room log houses, cattle drives and river commerce have given way to diverse possibilities as the city has grown to over 44,000 residents.

The architecture at Heathcote captures the history of the region. A traditional Seminole Indian chikee serves as an open air classroom for children. A replica Pioneer House, which was built using traditional tools and materials, is an example of early Florida "Cracker" architecture. The Heathcote House is a heart-of-pine 1922 vernacular Victorian.

Historic agricultural displays are in the Heathcote Master Plan, to depict the areas rich past in pineapples and citrus, and to demonstrate the promising future of bio-fuels and community supported agriculture.

2000

The City of Fort Pierce and St. Lucie County purchase the adjacent Tradewinds Mobile Home Park to add 1.5 acres to the Botanical Gardens, for a total of 5 acres.

2002

Dedication of the Pioneer House is held, honoring Pete Peterson. Sponsors include First Union Bank, Alto (Bud) Adams, Jr. and Diamond R Fertilizer.

2003

St. Lucie County and City of Fort Pierce recognize potential for a linear park to provide public recreation, open space and conservation of critical green space. City grants Heathcote \$85,000 for master planning, which is completed by landscape design firm, EDAW.

2004

The master plan enables St. Lucie County to win a \$3.2 million Florida Communities Land Trust to purchase the first 64 acres (Phase 1) of the linear park lands from the City of Fort Pierce.

On the day of the grant award, September 3, Hurricane Frances hits Fort Pierce. 20 days later, Hurricane Jeanne follows. The Gardens incur over \$250,000 in damage. 75% of the Gardens trees are lost.

Staff and volunteers led by Hayslip Landscape, Aiello Landscape, Haupt Roberts and Florida Native Nursery work to clear the debris and destruction. The 17th Annual Garden Festival is held in November despite the hurricane damage.

## 2005

Roy Rood retires, and returns the 3-headed Sabal to Heathcote Botanical Gardens.

## 2006

Heathcote Botanical Gardens celebrates its 20th Anniversary. The Heathcote Royal Palm Leadership Giving Society is established.

\$29,700 grant from State of Florida Department of Urban and Community Forestry, enables remedial pruning of storm-damaged tree canopy.

\$5,000 grant from Treasure Coast Regional Planning Council enables environmental study of Phase 1 lands.

## 2007

St. Lucie County, City of Fort Pierce and Heathcote approve Interlocal agreement to develop Phase 1 lands using \$3 million of the Florida Communities Trust funds which purchased the land from the City.

\$40,011 grant from the Treasure Coast Resource and Development Council enables removal of exotic vegetation from Phase 1 lands.

Heathcote issues Request for Qualifications to select design firm for developing Phase 1.

## 2008

\$51,256 Florida State Department of Urban and Community Forestry enable planting of 216 native trees to help restore lost canopy.

## 2009

Design firm Glatting Jackson Kircher Aglin, Inc. selected to update master plan and create construction documents for Phase 1. Project stakeholders include South Florida Water Management, Army Corp. of Engineers, Department of Environmental Protection, Transportation Planning Organization and Department of Transportation.

Donation of 100 tropical bonsai trees given to Heathcote by Bonsai Master James J. Smith.

## 2010

\$148,720 St. Lucie County Tourist Development grant awarded to Heathcote to build display garden for the James J. Smith Collection. Landscape and architectural designs donated by Hayslip Landscape and Peter Moor Architects.

Creation of construction documents for Phase 1 begins. Featured elements include blueway and greenway connectivity to the County Savannas, public access to 23-acre lake, lake pier and overlook, playground, upland and wetland restoration, and reconfiguring stormwater canals and lake to increase storage capacity and residual treatment time for stormwater.

\$1 million grant application to St. Lucie River Issues Team for re-engineering the stormwater system ranked number one for funding out of 12 competing projects. Funding is dependent upon Florida's state budget for 2011.

The Story Continues...  
*and you*  
*can write the next chapter!*

- ◆ Membership
- ◆ In-Kind Gifts
- ◆ Sponsorships
- ◆ Planned Giving
- ◆ Corporate underwriting
- ◆ Naming opportunities
- ◆ Leadership Giving



# Design

## Conceptual Master Plan – Existing Gardens





RODNEY ROBINSON  
LANDSCAPE ARCHITECTS, INC.  
2115 South Orange Avenue  
Suite 200  
Orlando, Florida 32809  
Tel: 407.241.1111  
Fax: 407.241.1112

Project Name  
Hatchcote Biological Center  
MASTER PLAN  
218 S. Orange Blvd.  
P.O. Box 1000  
Orlando, Florida 32802-3007

Sheet Title  
SITE PLAN

Revision	Date

Sheet No.  
L0  
Drawn: JPD  
Checked: JPD  
Scale: 1"=200'  
Date: August 1, 2010

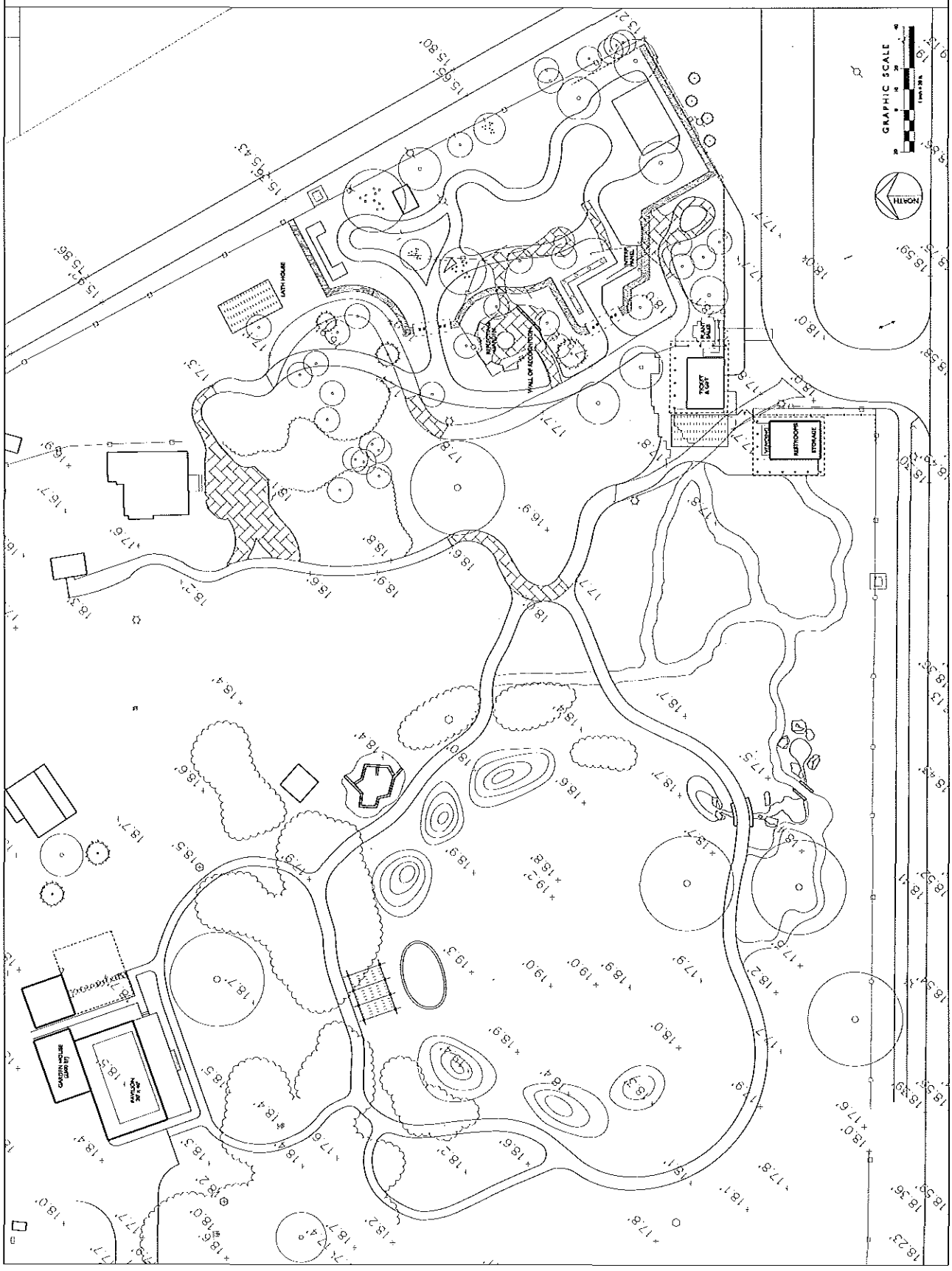







## Heathcote Botanical Gardens

210 Savannah Road, Fort Pierce, Florida 34982

info@HeathcoteBotanicalGardens.org

(772)464-4672

Contact: Amy Dahan

adahan@heathcotebotanicalgardens.org

**PRESS RELEASE - FOR IMMEDIATE RELEASE**

### Heathcote Announces Major Gift!

October 9, 2009: Bonsai Master Jim Smith has made a pledge to Heathcote Botanical Gardens of a substantial number of bonsai from his extensive sub-tropical collection. Several of his beautiful trees are part of the permanent collection in Heathcote's Japanese Garden, which currently features nine bonsai.



*Sub-tropical ficus bonsai by Master Jim Smith*

the new bonsai collection in accordance with Jim Smith and the Bonsai Society's recommendations.

Jim Smith is recognized as a master in the world of bonsai. In addition to winning multiple awards, and exhibiting at state, national and international conventions, Mr. Smith's bonsai are displayed at the National Arboretum in Washington D.C., Epcot's annual garden show, and the Pacific Rim Bonsai Society in the state of Washington.

In 1975, Mr. Smith helped found the Treasure Coast Bonsai Society. There were 25 or 30 charter members, and Jim Smith and Heathcote Botanical Gardens' Gloria Moore are the last two remaining of that group. In 1979, he closed his plastering business and opened the Dura-Stone Nursery at 304 Old Dixie Highway in Vero Beach. Over the years, Mr. Smith has mentored many students and members of the Bonsai Society, and helped Florida become recognized as a major contributor to the bonsai community.

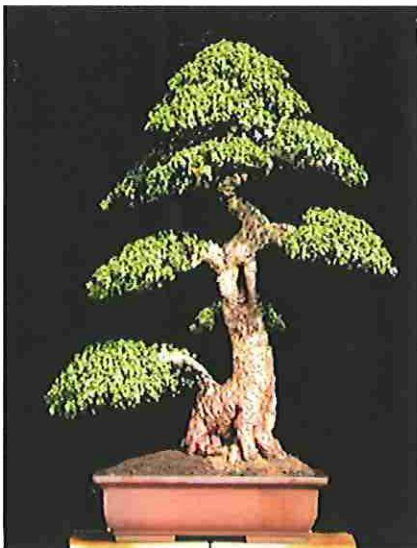

*Portulacaria Afra "Jade Tree"*  
By Jim Smith

"The significance of this gift is tremendous," stated Landscape Architect Rodney Robinson. Mr. Robinson and Heathcote's master planners, Glatting Jackson, recently met with Jim Smith, and Treasure Coast Bonsai Society members Richard Turner and Jim Van Landingham to discuss Jim's proposal. The gift is contingent upon Heathcote being able to properly secure, display and maintain the trees. His gift would give Heathcote one of the largest public displays of bonsai in the country, comparable to the Chicago Botanical Garden and New York Botanical Garden collections, and would require a full-time curator.

All parties agreed that Heathcote's existing five acres is the best location for the collection. As plans are being made for the adjoining 150-acre botanical park, Rodney Robinson has been focusing on developing the unique character and heritage of the existing Gardens' five acres.

His preliminary drawings for the Gardens preserve and build upon its best features, and include situating



*Gloria Moore and Jim Smith*

Mr. Smith has envisioned a unique display for his magnificent collection. A traditional bonsai display may feature trees displayed in rows on slatted tables. In keeping with Heathcote's charming pathways, Mr. Smith suggested winding paths where visitors will "discover" a bonsai at every turn. *Shimrin-yoka* is a Japanese term that refers to the therapeutic effects of strolling in the forest, and Heathcote bonsai display will impart that serene and restorative experience. The collection curator, Jim Van Landingham, landscape designer Sam Comer of Hayslip Landscape and Architect Peter Moor of Moor & Associates have donated their professional services to the project, which will be under construction by April 2010.

For more information about the James J. Smith Collection at Heathcote, contact:

Heathcote Botanical Gardens

210 Savannah Road

Fort Pierce, Florida 34982

(772) 464-4672

www.heathcotebotanicalgardens.org

*HEATHCOTE*  
*Botanical Gardens*

*Bonsai Curators Sneak Preview*

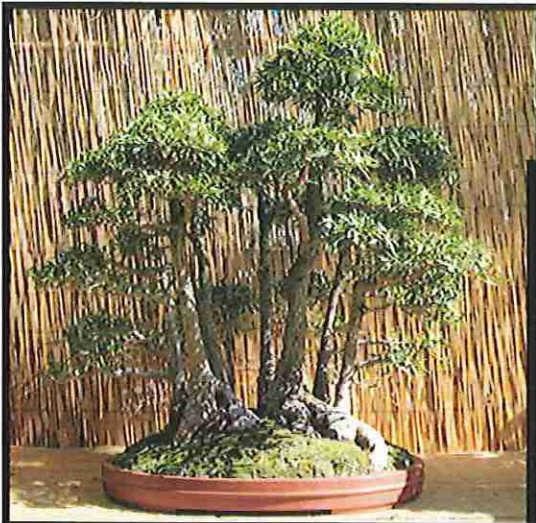

Sneak preview of the bonsai that will be in the collection, and progress of work on The James J. Smith Bonsai Garden.

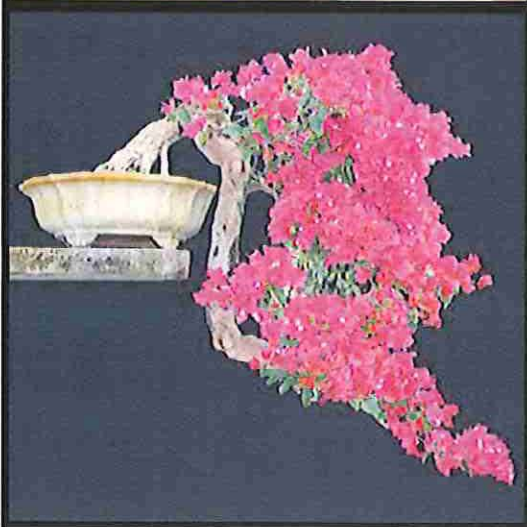

Special thanks and recognition to Sam Comer for his contributions to the new Bonsai Garden. Not only has he donated the design and much time and equipment to the demolition, he came in on Sunday and personally graded the entire site *without breaking a single waterline* (now that's talent!)

*For Membership or a Contribution contact Amy Dahlan @ (772) 464-4672*

This is a very rough sketch for the placement of the walkway and the pavilion.  
And excerpts of e-mails from Amy Dahan



View of the pavilion  
from the entrance

Sam's generosity saves us much needed money in the bonsai budget, and of course, he also brought in the pro bono service of Peter Moor to design the pavilion, and a \$35,000 donation to help build it. Thank you, Sam!



View from the pavilion  
looking at the collection

RK Davis is expecting materials to be delivered Thanksgiving week, with 8 weeks to complete pavilion construction. Meanwhile, infrastructure will be installed. We hope to complete pathways, stands and landscaping during the month of February.



Closer look at the north end of  
the garden

Jim Gaines did a tremendous job of getting the demolition and relocation completed last spring. He has agreed to keep the construction moving for us now. Many thanks, Jim!

Amy Dahan  
Director  
Heathcote Botanical Gardens

The Bougainvillea are putting on a show at Dura Stone Bonsai Nursery. The volunteers have been working very hard. 75% of the trees are at show readiness.

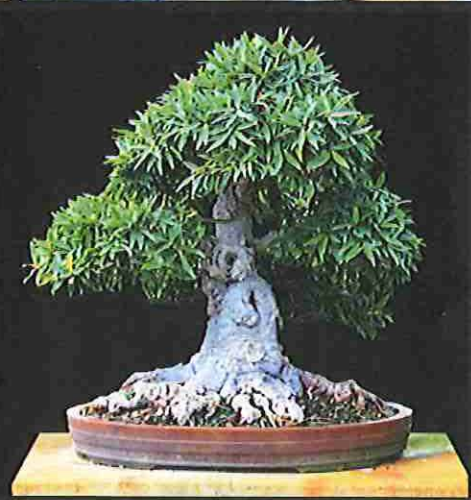
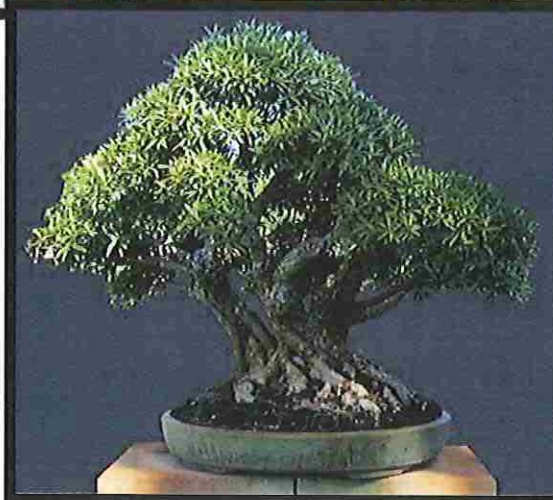

*Bonsai Curator Patrick Giacobbe*

